



ICT Department

Set up the PPTP - VPN client on Windows 10:

The following steps outline how to configure a Windows 10 VPN client to access Library Research Databases subscribed by NLUO from outside of NLUO Local Area Network(LAN) / Wi-Fi from Internet.

1. Right-click the **Start button**.
2. Click **Settings**.





ICT Department

3. Click **Network & Internet**.

4. Click **VPN**.

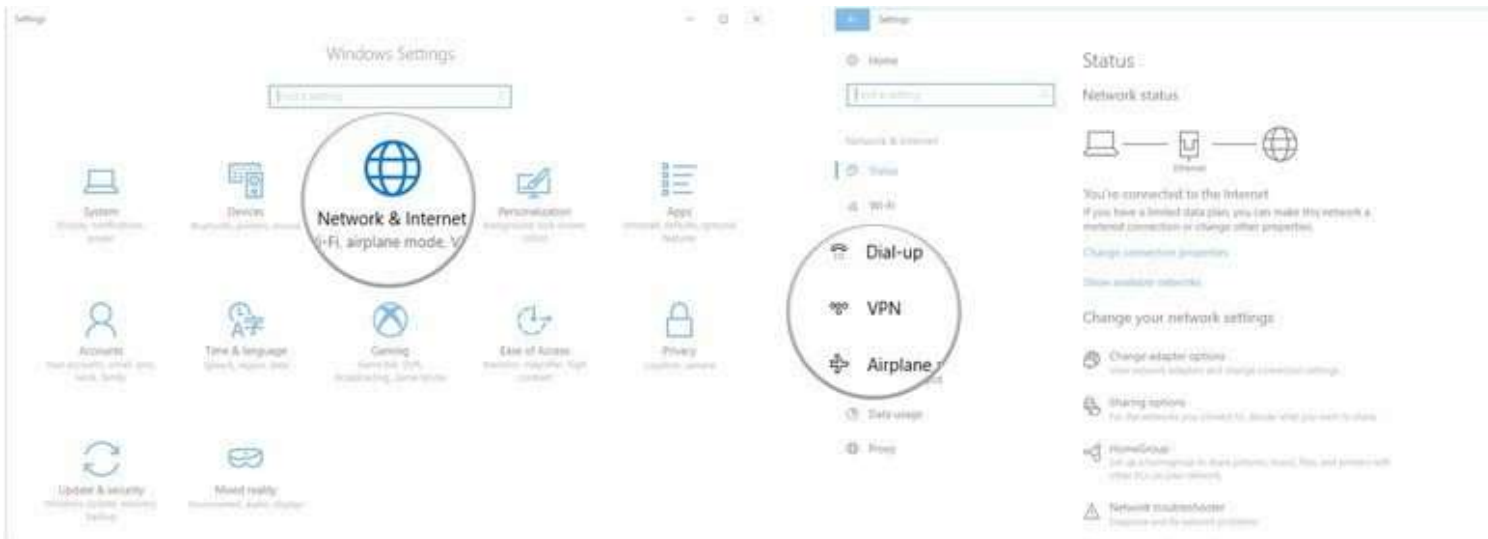

5. Click **Add a VPN connection**.

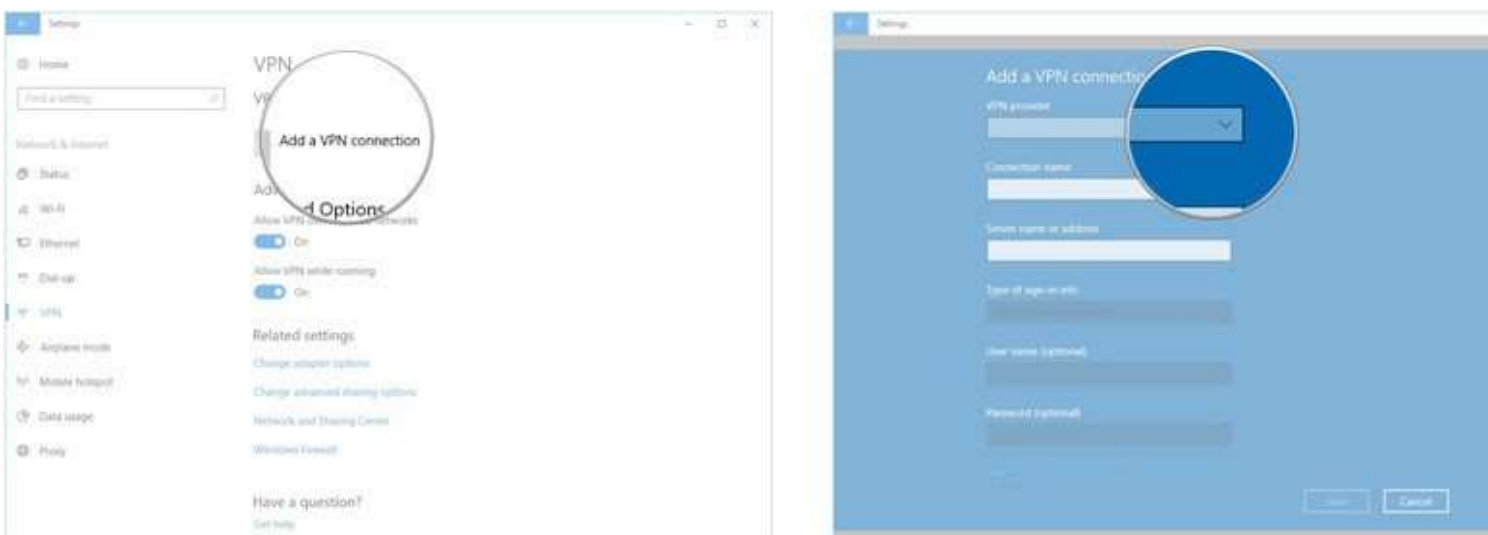



ICT Department

6. Click the **dropdown menu** below **VPN provider** and select **Windows (built-in)**.
7. Click the **Connection name** field and type **NLUO Library Research Databases**.
8. Click the **Server name or address** field and type the **server's IP address- 14.139.213.70**
9. Click the **dropdown menu** below **VPN type** and select **Point to Point Tunnelling Protocol (PPTP)**.
10. Click the **dropdown menu** below **Type of sign-in info** and select **User name and password**.
11. Click **Save**.
12. Click the **VPN** you just set up. (It will now appear in the VPN list.)
13. Click **Connect** and use your **Cyberoam Username** and **password** to connect.

Add a VPN connection

VPN provider
Windows (built-in)

Connection name
NLUO Library Research Databases

Server name or address
14.139.213.70

VPN type
Point to Point Tunneling Protocol (PPTP)

Type of sign-in info
User name and password

User name (optional)

Password (optional)

Save

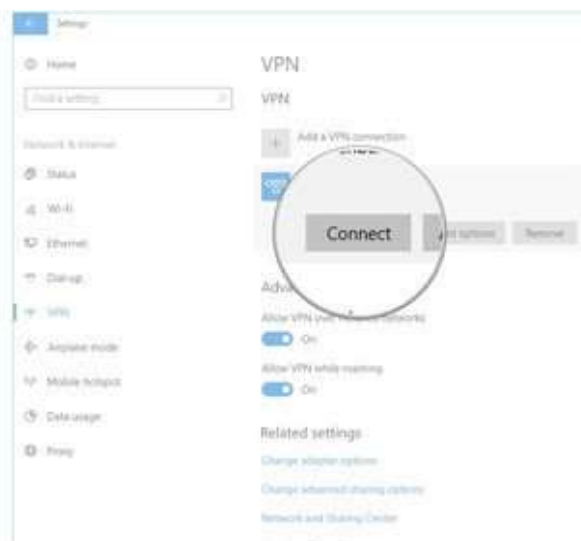
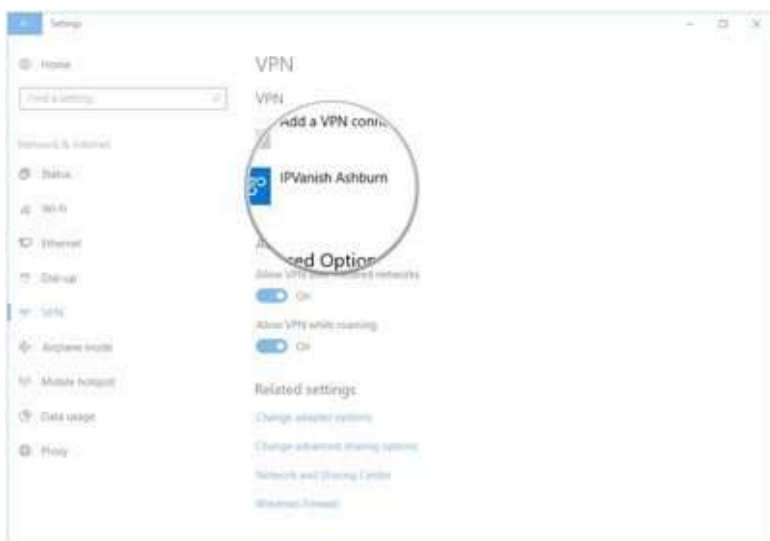



National Law University, Odisha
(established by Govt. of Odisha Act IV of 2008)

ICT Department

Note:

- This will work only from outside the NLUO Local Area Network (LAN) / Wi-Fi from Internet.
- Only allowed Cyberoam users will be able to use this facility.